

# ST7000+ Autopilot Control Head Service Manual

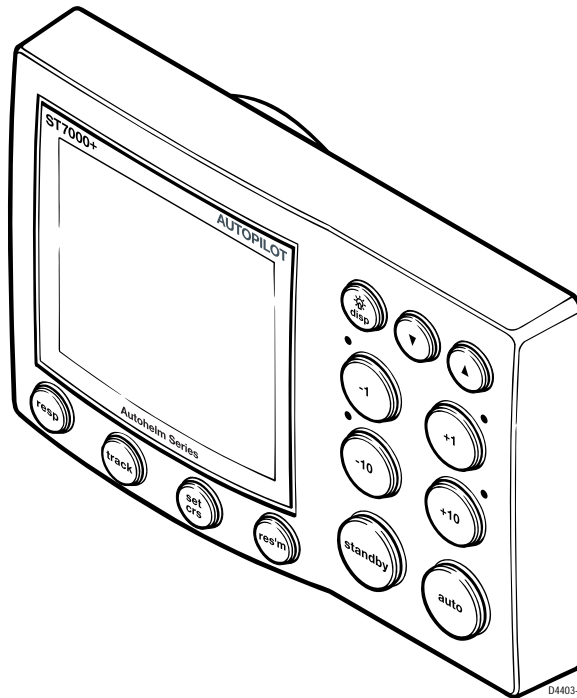

A12001

## Warning

### CE Marking of Equipment/Replacement Parts

If the Raytheon equipment under repair, test, calibration, installation or setting to work carries the European CE mark, only parts and components supplied or approved for such use by Raytheon should be used in order to maintain compliance with the relevant CE requirements.

Incorporation, use or attachment, by any means, of parts or components not supplied for or not approved for such use by Raytheon or, if supplied or approved for use by Raytheon, not properly fitted in accordance with instructions published, provided or recommended by Raytheon, may cause the equipment to malfunction and, in particular, to become unsafe or to no longer meet the relevant CE requirements. In these circumstances, Raytheon Marine Europe Ltd excludes liability to the fullest extent permissible in law for any loss or damage including any liability for its contribution to such loss or damage by its negligent acts or omissions.

# Chapter 1. Disassembly/Assembly

A12001

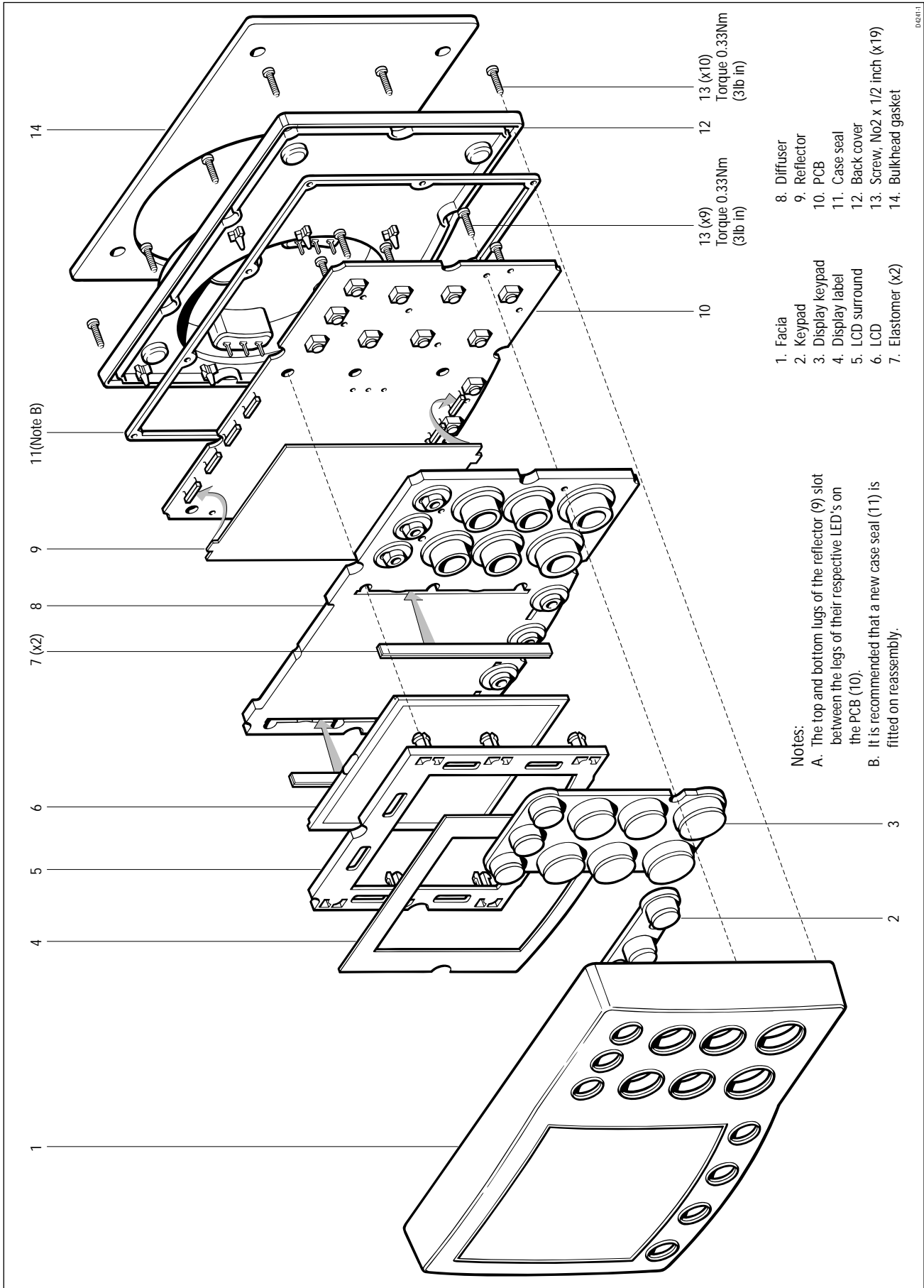

Figure 1: ST7000+ Autopilot Control Head exploded view

## 1.1 ST7000+ Autopilot Control Head spare parts list

The **item** numbers refer to

Figure 1: ST7000+ Autopilot Control Head exploded view

Item	Spare Description	Part No.	Comments
1	Facia	A18001	
2	Keypad set, <i>including</i> Keypad	A18003	
3	Display keypad		
4	Display kit, <i>including</i> Display label	A18004	
5	LCD surround		
6	LCD		
7	Elastomer (x2)		
8	Diffuser kit, <i>including</i> Diffuser	A18005	
9	Reflector		
10	PCB assembly	A18006	
11	Case seal	A18007	
12	Back cover	A18002	
14	Bulkhead gasket	A18008	
-	Sun cover	A15001	Not illustrated

On reassembly, it is recommended that the PCB assembly (10) is fixed to the facia (1) using a torque of 0.33Nm (3lb in). Similarly, fixing the rear case (12) to the facia (1) must be torqued to 0.33Nm (3lb in).

**Note:** It is recommended that a new case seal (11) is fitted on reassembly.

## Chapter 2. PCB details

### 2.1 Input/Output signals

(refer to Figure 2. ST7000+ Autopilot Control Head circuit diagram)

Wire colour	Circuit diagram reference	Description
Red	P1/P4	+12V nominal DC supply.
Yellow	P3/P6	SeaTalk data. Intermittent streams of +12V (nominal) pulses.
Screen	P2/P5	0V supply and signal return.
Red	P7	NMEA in. Data positive.
Blue	P8	NMEA in. Data negative.

Circuit diagram

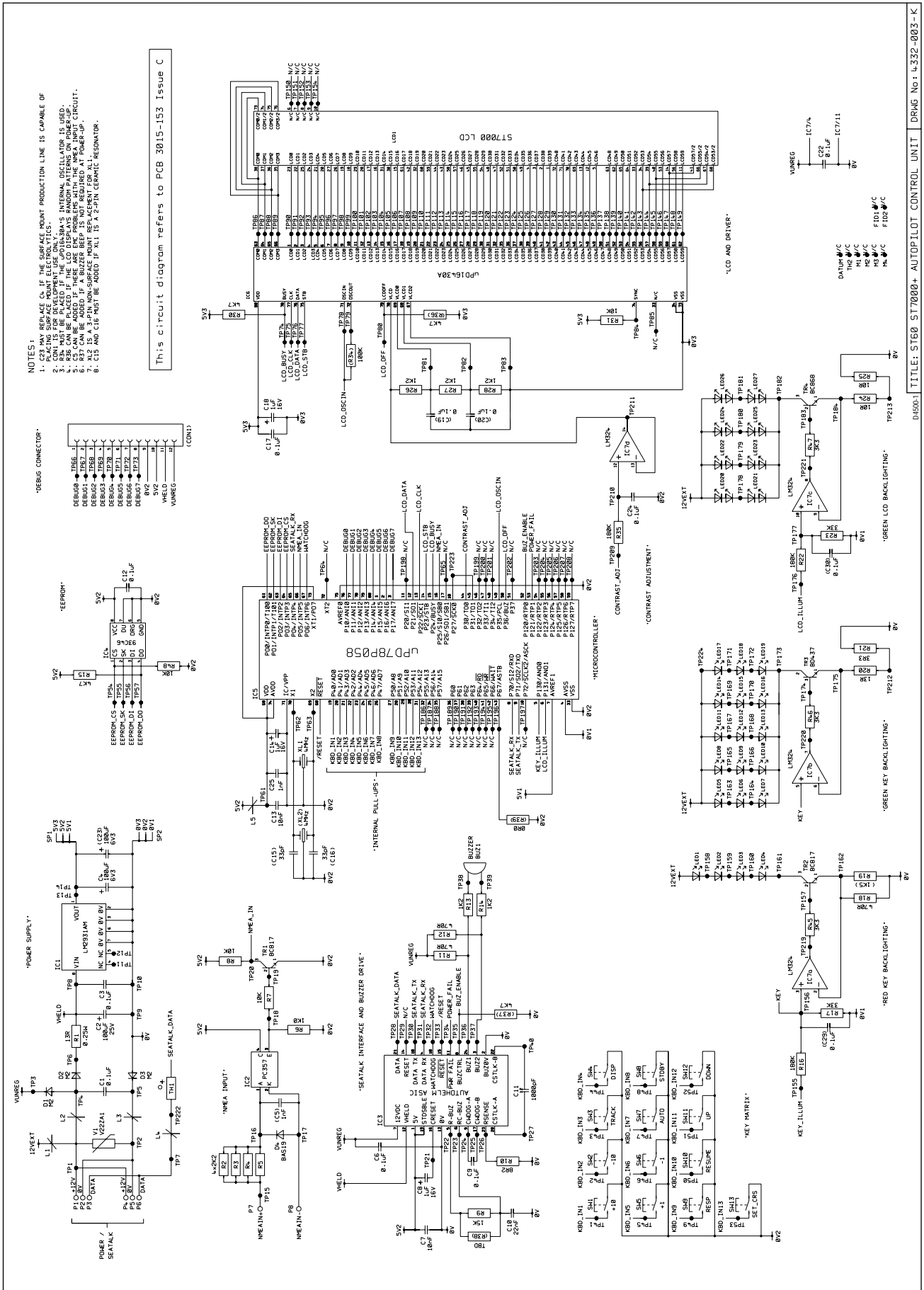
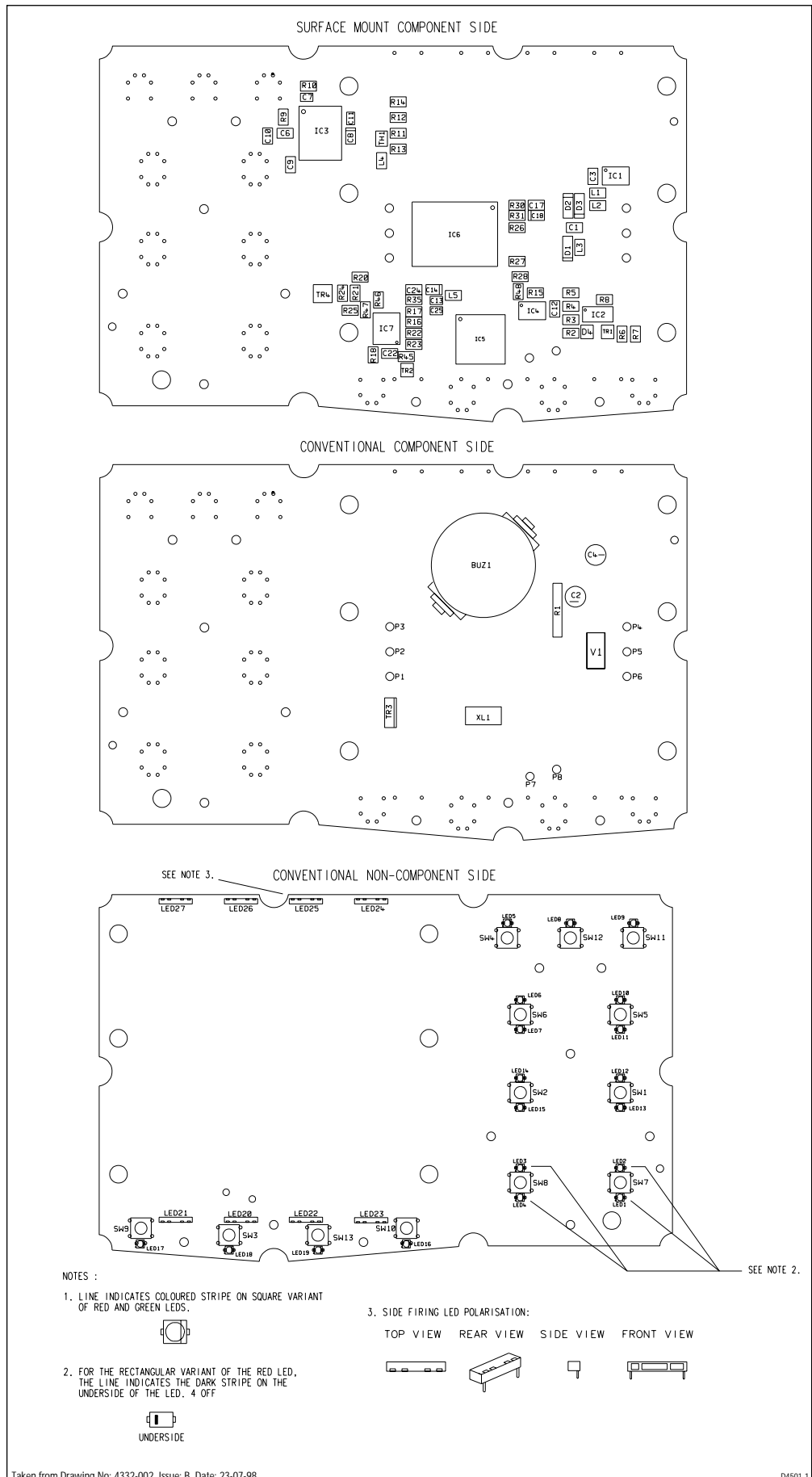

Figure 2. ST7000+ Autopilot Control Head circuit diagram

A12001

## 2.2 PCB Layout

A12001



## Component List

### SURFACE MOUNT COMPONENT SIDE

9600L1	5	SOLID CHIP INDUCTOR	L1-5
9600THERM3	1	THERMISTOR	TH1
9400LM324	1	IC QUAD OPAMP LM324	IC7
940016430A	1	IC LCD DRIVER $\mu$ PD16430A	IC6
940378P058	1	IC OTP MICRO 78P058 80PIN QFP (ST7000+ V1 SOFTWARE)	IC5
9400ST93C46CM1	1	IC E2PROM STC46CM1 S08	IC4
9401RLA80	1	IC ASIC RAYTHEON	IC3
9400PC357D	1	IC OPTO ISOLATOR PC357N4T	IC2
9400LM2931AM	1	IC REGULATOR LM2931AM S08	IC1
9204D1F10	3	DIODE RECTIFIER D1F10 1A 100V	D1-3
9200BAS19	1	DIODE SOT23 BAS19	D4
9500BC817	2	TRANSISTOR SOT23 BC817 NPN	TR1,2
9501BC868	1	TRANSISTOR SOT89 BC868 NPN	TR4
93091U	3	CAPACITOR TANT 1 $\mu$ F 16V 10% SIZE A	C8,14,18
93041000P	2	CAPACITOR X7R 0805 1000pF 50V 10%	C11,25
930522N	1	CAPACITOR X7R 1206 22nF 50V 5%	C10
93040U01	2	CAPACITOR X7R 0805 0.01 $\mu$ F 50V 10%	C7,13
93070U1	8	CAPACITOR X7R 1206 0.1 $\mu$ F 50V 20%	C1,3,6,9,12,17,22,24
91063K3	3	RESISTOR 1206 3K3 5% 0.125W	R45-47
910310R	2	RESISTOR 1206 10R 1% 0.125W	R24,25
91063R3	1	RESISTOR 1206 3R3 5% 0.125W	R21
910313R	1	RESISTOR 1206 13R 1% 0.125W	R20
910333K	2	RESISTOR 1206 33K 1% 0.125W	R17,23
9103180K	3	RESISTOR 1206 180K 1% 0.125W	R16,22,35
91064K7	2	RESISTOR 1206 4K7 5% 0.125W	R15,30
91031K2	5	RESISTOR 1206 1K2 1% 0.125W	R13,14,26-28
9106470R	3	RESISTOR 1206 470R 5% 0.125W	R11,12,18
91068R2	1	RESISTOR 1206 8R2 5% 0.125W	R10
910315K	1	RESISTOR 1206 15K 1% 0.125W	R9
910610K	4	RESISTOR 1206 10K 5% 0.125W	R7,8,31,48
91031K	1	RESISTOR 1206 1K 1% 0.125W	R6
91062K2	4	RESISTOR 1206 2K2 5% 0.125W	R2-5
3015-153	1	PCB ST7000+	

### CONVENTIONAL COMPONENT SIDE

3030-035-C	8	SOLDER BUCKETS	P1-8
15087	1	BUZZER KYOCERA KBS-27 DB-3T	BUZ1
01051	1	VARISTOR GE TYPE V22ZA1	V1
15314	1	RESONATOR CERAMIC MURATA CST4.00MGW	XL1
-	-	-	-
05014	1	TRANSISTOR BD437	TR3
03062	1	CAPACITOR ELEC 100 $\mu$ F 6.3V +/-20% RADIAL	C4
03100	1	CAPACITOR ELEC LOW IMP 100 $\mu$ F 25V +/-20%	C2
01183	1	RESISTOR METAL FILM SFR25 13R +/-5% 0.4W	R1

### CONVENTIONAL NON-COMPONENT SIDE

15165	8	LED SEGMENT 2 CHIP GREEN	LED20-27
02050	15	LED GREEN HLMP6505	LED5-19
02076	4	LED RED HLMPQ101	LED1-4
06030	13	SWITCH ALPMIN	SW1-13

Taken from Drawing No: 4332-002 Issue: B Date: 23-07-98

D4502-1

A12001

Raytheon Marine Company  
Recreational Products  
Anchorage Park  
Portsmouth, Hampshire  
England PO3 5TD  
Telephone 01705 693611  
Fax 01705 694642  
[www.raymarine.com](http://www.raymarine.com)

Raytheon Marine Company  
Recreational Products  
676 Island Pond Road  
Manchester  
NH 03109-5420, USA  
Telephone 603.647.7530  
Fax 603.634.4756  
[www.raymarine.com](http://www.raymarine.com)

**Raytheon**